

# RAK-ORIGIN

## Wall Hung | Water Closet

**RAK**  
CERAMICS

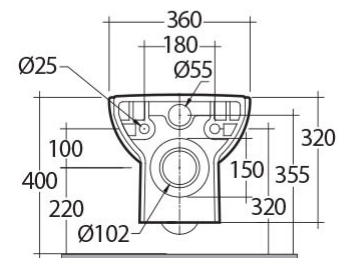
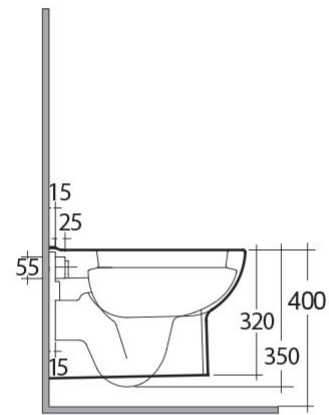
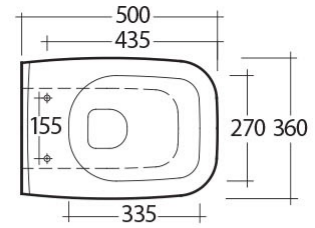

### Technical specifications

Dimensions: 500 x 360 mm

Weight: 20 Kg

Color: Alpine White

Trap type: P Trap

Trapway type: Concealed

Seat cover options: PP

Bowl shape: Rounded Rectangle

Soft close: yes

Suites: [RAK-ORIGIN](#)

**Code**      **Name**

ORIWHPAN    ORIGIN WATER CLOSET WALL HUNG 50CM

Dimensions: All dimensions in mm tolerance  $\pm 5\%$  for below 200mm and  $\pm 3\%$  for above 200mm.

Note: Due to a continuing development programme to improve design and performance, the manufacturer reserves all rights to vary specifications without prior information.

Please note accessories are for photographic use only.