

Technical Data Information

Product Code:	TR05
Information:	Aurora Mono Basin Mixer
Construction	Brass Body CuZn40Pb2, EN CW617N (equivalent to BS CZ122)
Finishes	Chrome plated to BS EN 248
Product Type	Contemporary
Water Pressure	Min. 0.2 bar, Max. 6.0 bar
Plumbing Systems	Suitable for all plumbing systems
Standards	Complies with BS5412, BS EN200
Certification	Manufactured to comply with WRAS
Cartridge	35mm Triduo ceramic disc cartridge
Aerator	Neoperl Adjustable Slim air
Fitting	UK: M10 x 350mm 1/2" BSP Female Flexi Tails . EU: M10x350mm 3/8" BSP Female Flexi Tails.
Packaging	46x28.5x34.5cm/carton(8pcs), Box size: 27.5x22.5x8cm, Weight: 1.95kg
Guarantee	10 years against manufacturing faults (excluding serviceable parts).
Additional Information	1.Supplied with G 1 1/4" sprung waste(UK only) 2.Incorporates water saving optional feature : Triduo Volume Limiter

Overall Dimensions:

H: 157 x D: 130 x W: 55



Volume Limiter

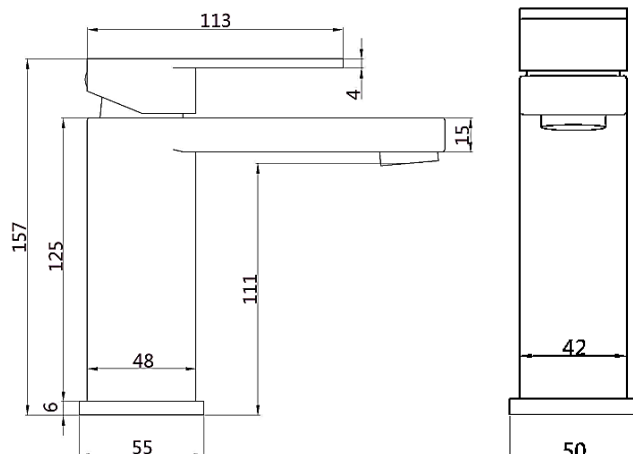

All Dimensions are in millimetres. The information contained on this page was correct at date of issue. Fitting dimensions are provided as a guide only. Some variation may occur due to manufacturing tolerances. We pursue a policy of continuing improvement in design and performance of our products and so reserve the right to change specifications without prior notice.